

SECTION E: STRUCTURE PLANS

REQUIRED LIST	
1 Section E Title	5 Map of Project
2 Project Block	6 Structure Number and Location
3 Index of Sheets	7 Begin and End of Project
4 North Arrow	

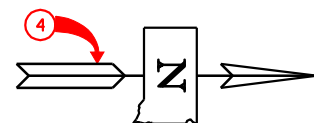

INDEX OF SHEETS -

Sheet E1	Layout Map and Index
Sheet E2	Estimate of Structure Quantities
Sheet E3 to E8	Site 1: Alternate A 2 - 6' x 3' Box Culvert (C.I.P.)
Sheet E9 to E12	Site 1: Alternate B 2 - 7' x 3' Box Culvert (Precast)
Sheet E13 to E17	Site 2: Alternate A 9' x 3' Box Culvert (C.I.P.)
Sheet E18 to E21	Site 2: Alternate B 9' x 4' Box Culvert (Precast)
Sheet E22 to E27	Site 3: Alternate A 6' x 3' Box Culvert (C.I.P.)
Sheet E28 to E31	Site 3: Alternate B 7' x 3' Box Culvert (Precast)
Sheet E32 to E39	2 - 8' x 7' Box Culvert (C.I.P.)
Sheet E40 to E46	2 - 9' x 3' Box Culvert (C.I.P.)
Sheet E47 to E60	Bridge Repair for 254' - 0" Cont. Comp. Girder Bridge

Str. No. 02-180-179
2 - 8' X 7' Box Culvert (C.I.P.)

Str. No. 02-180-201
Site 3: Alternate A: 6' X 3' Box Culvert (C.I.P.)
Site 3: Alternate B: 7' X 3' Box Culvert (Precast)

Str. No. 02-180-165
Bridge Repair for
254' - 0" Cont. Comp. Girder Bridge

Str. No. 02-180-246
Site 1: Alternate A: 2 - 6' X 3' Box Culvert (C.I.P.)
Site 1: Alternate B: 2 - 7' X 3' Box Culvert (Precast)

BEGIN P 0281(75)59

Station 10+00 = 664+85.5 on S 196(5)
Approximately 13.00 feet East of
the West Quarter corner of
Sec 19 - T101N - R63W
M.R.M. = 59.00+0.219

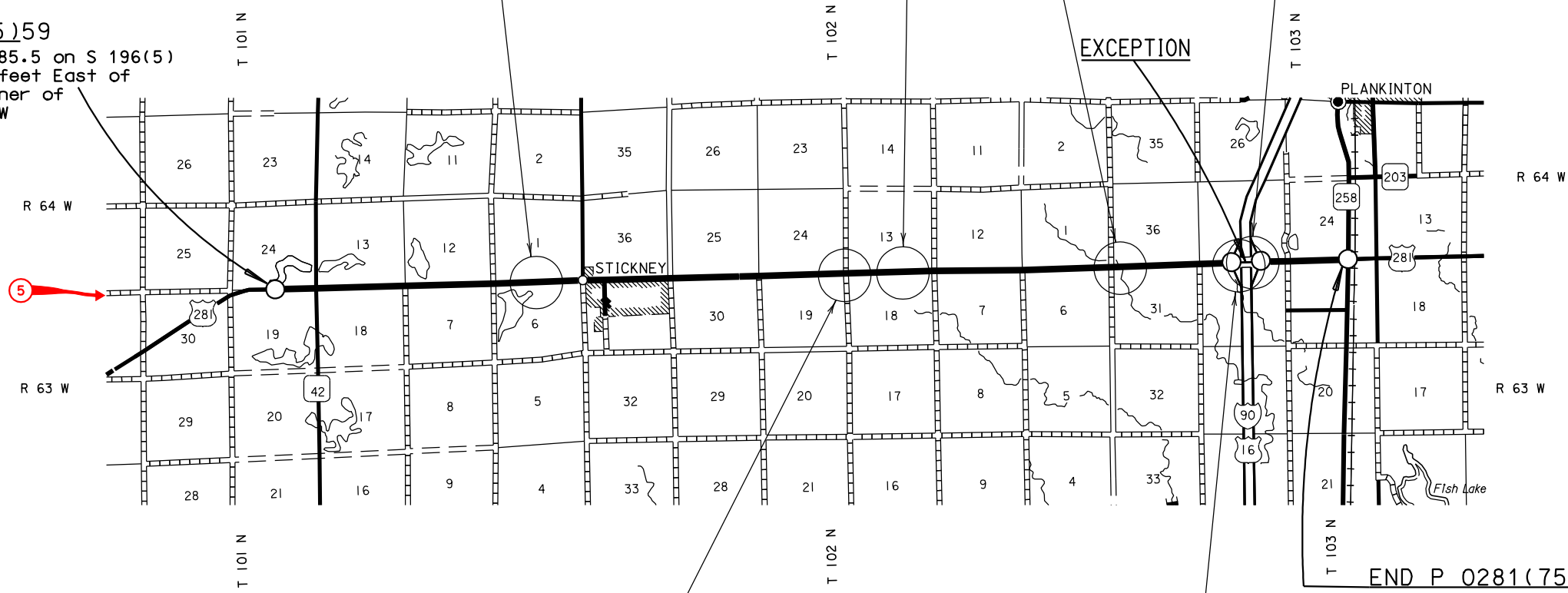

Str. No. 02-180-210
Site 2: Alternate A: 9' X 3' Box Culvert (C.I.P.)
Site 2: Alternate B: 9' X 4' Box Culvert (Precast)

Str. No. 02-180-167
2 - 9' X 3' Box Culvert (C.I.P.)

END P 0281(75)59

Station 657+80.89 = 16+94.82 on S 196(7)
Approximately 1099.08 feet North
of the West Quarter corner of
Sec 19 - T103N - R63W
M.R.M. = 71.48+0.021