

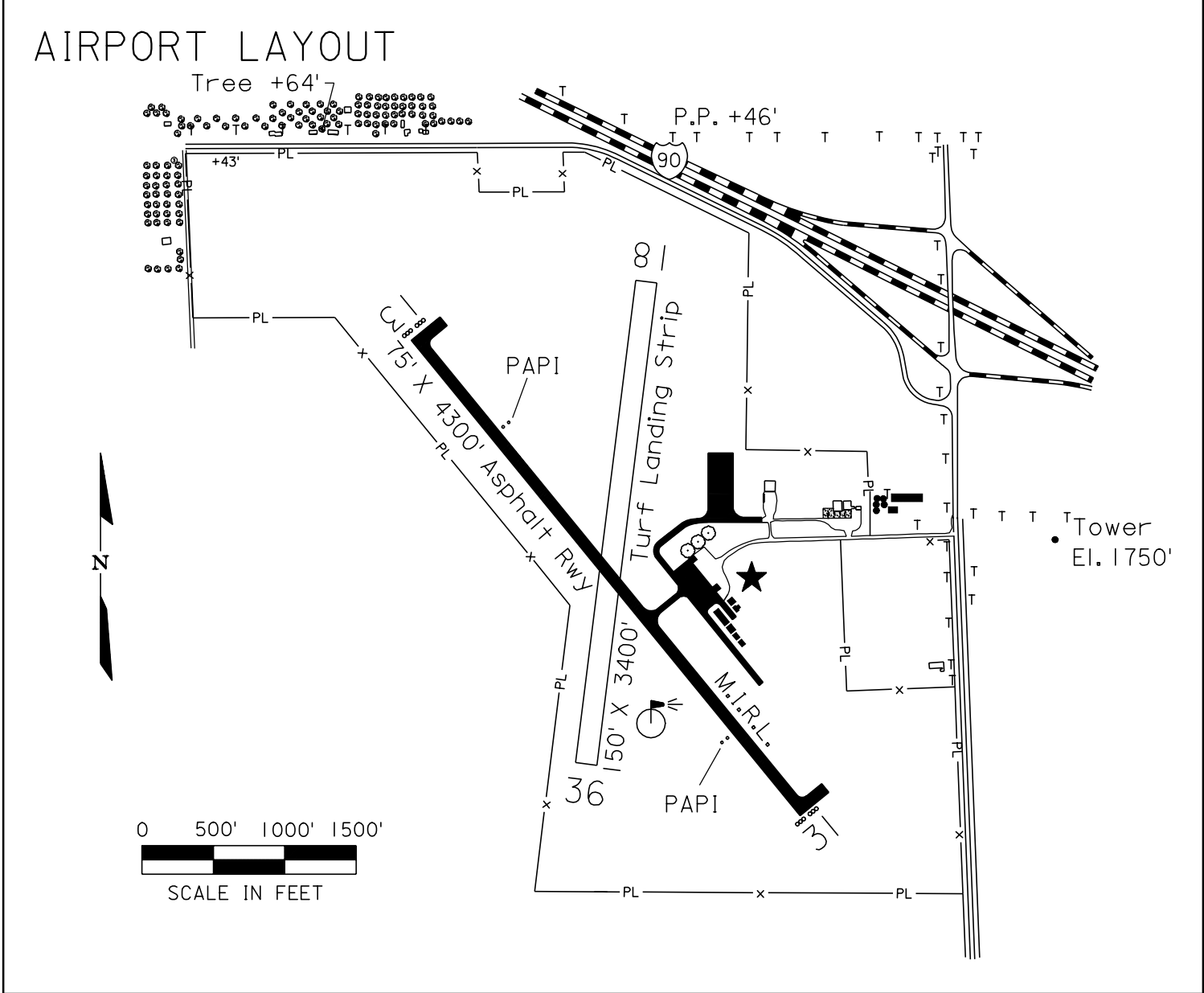

CHAMBERLAIN

Airport Ident 9V9  
CHAMBERLAIN

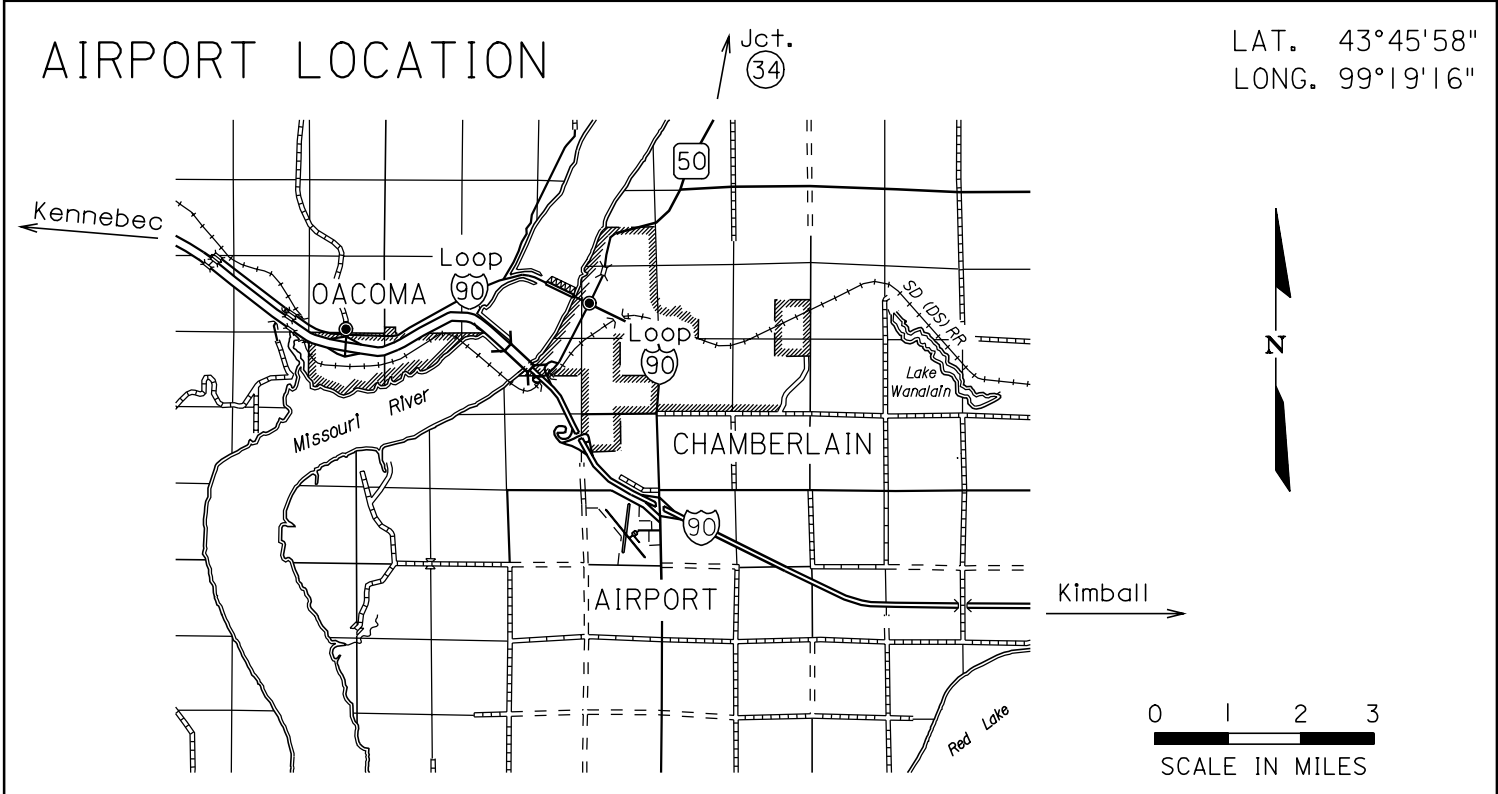

### AIRPORT ELEVATION 1696'

<p><b>RUNWAY SURFACE:</b> 13 / 31 Asphalt 18 / 36 Turf</p> <p><b>LIGHTED:</b> 13 / 31 and Beacon</p> <p><b>FUEL:</b> 100 LL, Jet A Credit Card - Self Service</p> <p><b>REPAIRS:</b> MINOR</p> <p><b>TRANSPORTATION:</b> None</p> <p><b>MEALS:</b> In Town</p> <p><b>MANAGER:</b> Dyrk Hrabe Home: (605) 734-6417, Airport: (605) 734-4409 cell number (605) 730-6417</p> <p><b>OWNER:</b> City of Chamberlain</p>	<p><b>RADIO:</b> Unicom 122.8</p> <p><b>NAV. AIDS:</b> GPS RWY 31</p> <p>Lights Key Mike: 122.8 3 Times Low Intensity &amp; PAPI's 5 Times Medium Intensity &amp; PAPI's 7 Times High Intensity &amp; PAPI's</p> <p><b>FSS:</b> 1-800-992-7433</p> <p><b>WEATHER:</b> FSS NWS ASOS - (605) 734-0428</p> <p><b>REMARKS:</b> Attended 24 Hours Telephone Available</p>
--	--

CHAMBERLAIN

Revised: 10/09