



Airport Ident 6E5  
**WILDER FIELD**

DeSMET

LAT. 44°25'55"  
 LONG. 97°33'31"

**AIRPORT LOCATION**

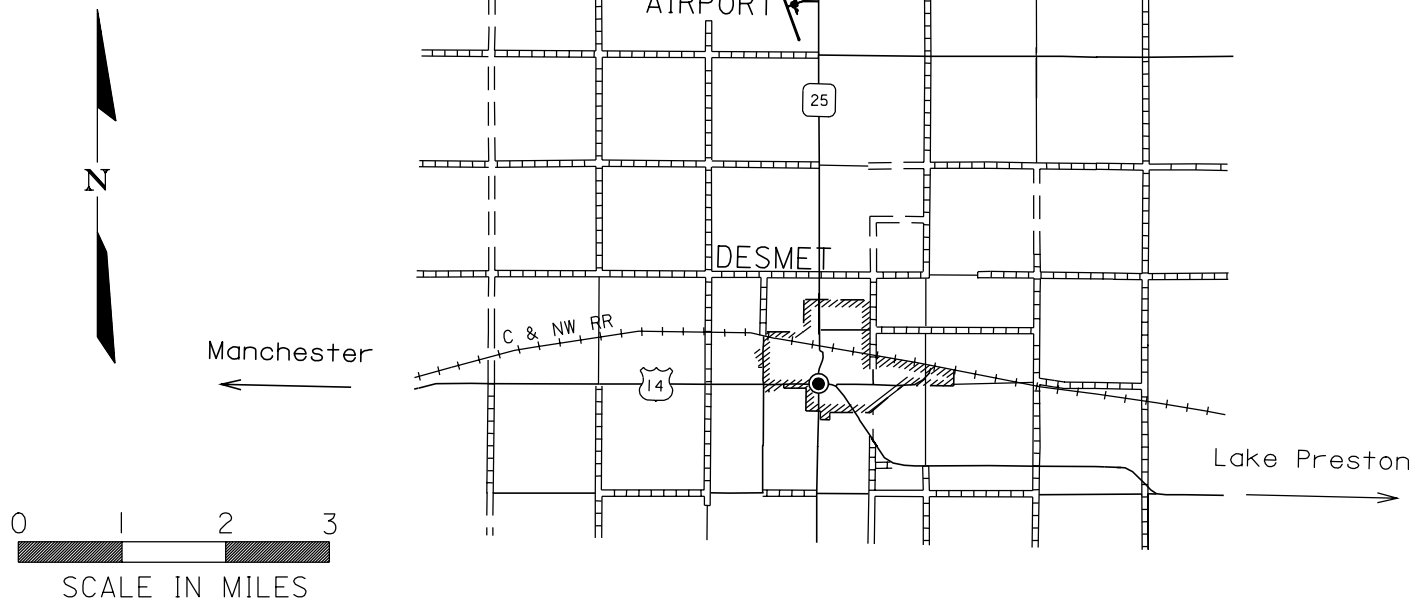

**AIRPORT LAYOUT**

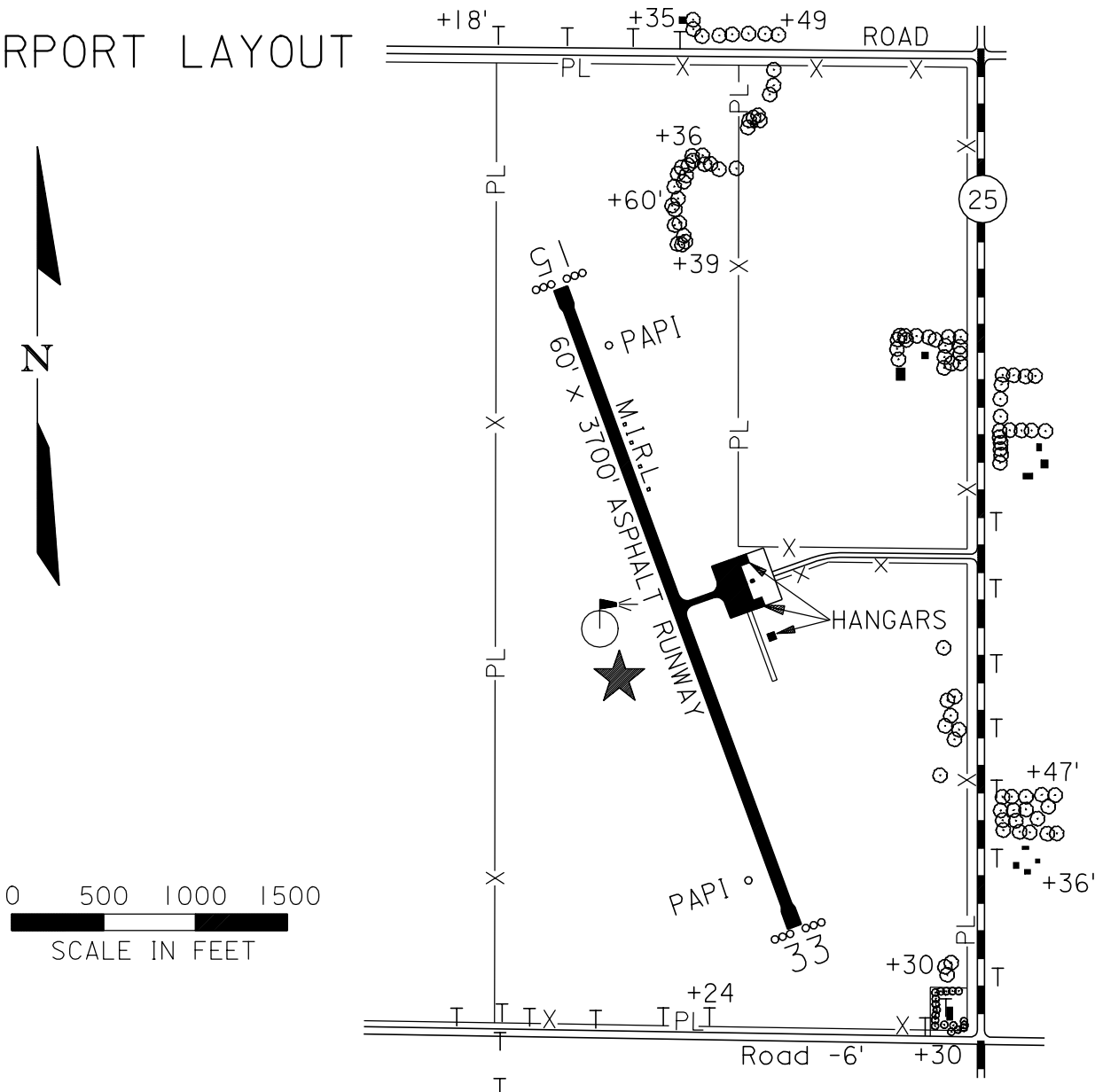

**AIRPORT ELEVATION 1729'**

<p><b>RUNWAY SURFACE:</b> 15 / 33 Asphalt</p> <p><b>LIGHTED:</b> 15 / 33 and Beacon</p> <p><b>FUEL:</b> NO FUEL</p> <p><b>REPAIRS:</b> None</p> <p><b>TRANSPORTATION:</b> None</p> <p><b>MEALS:</b> In Town</p> <p><b>MANAGER:</b> Ryan Petersen        (605) 860-1547        (605) 854-9161</p> <p><b>OWNER:</b> City of DeSmet        (605) 854-3731</p>	<p><b>RADIO:</b> None, CTAF 122.9</p> <p><b>NAV. AIDS:</b> PAPI's Runway 15 / 33        Lights Key Mike: 122.9        3 Times Low Intensity        5 Times Medium Intensity        7 Times High Intensity</p> <p><b>FSS:</b> 1-800-992-7433</p> <p><b>WEATHER:</b> FSS</p> <p><b>REMARKS:</b> Unattended        Telephone Available        Pilot's lounge</p>
--	---

Revised: 9/09