

CITY MAP

# COLOME

TRIPP COUNTY - SOUTH DAKOTA

T 98 N - R 75 W

SCALE



POP. 340 (2000)

2007

PREPARED BY

**SOUTH DAKOTA  
DEPARTMENT OF TRANSPORTATION**

IN COOPERATION WITH  
**U.S. DEPARTMENT OF TRANSPORTATION  
FEDERAL HIGHWAY ADMINISTRATION**

ALL STREET RIGHT OF WAY 80 FT.

ALLEYS 20 FT.

( UNLESS OTHERWISE INDICATED )

( UNOFFICIAL EDITION )

### LEGEND

- U.S. NUMBERED HIGHWAY
- U.S. NUMBERED INTERSTATE HIGHWAY
- STATE NUMBERED HIGHWAY
- STREAMS, CREEKS, AND OTHER WATERWAYS
- CANALS, LATERALS, IRRIGATION DITCHES WITH DIRECTION OF FLOW
- HARD SURFACE
- GRAVEL SURFACE
- EARTH SURFACE
  - UNIMPROVED
  - TRAIL
- GRADE
- CENTRAL BUSINESS DISTRICT
- TOWN CENTER (COUNTY SEAT)
- CITY LIMITS
- RAILROAD
- SCHOOLHOUSE
- FIREHALL
- BALL FIELD
- TOWNHALL
- WATER SUPPLY STAND PIPE OR TANK
- HIGHWAY GARAGE (C-COUNTY, S-STATE)
- POST OFFICE
- CHURCH

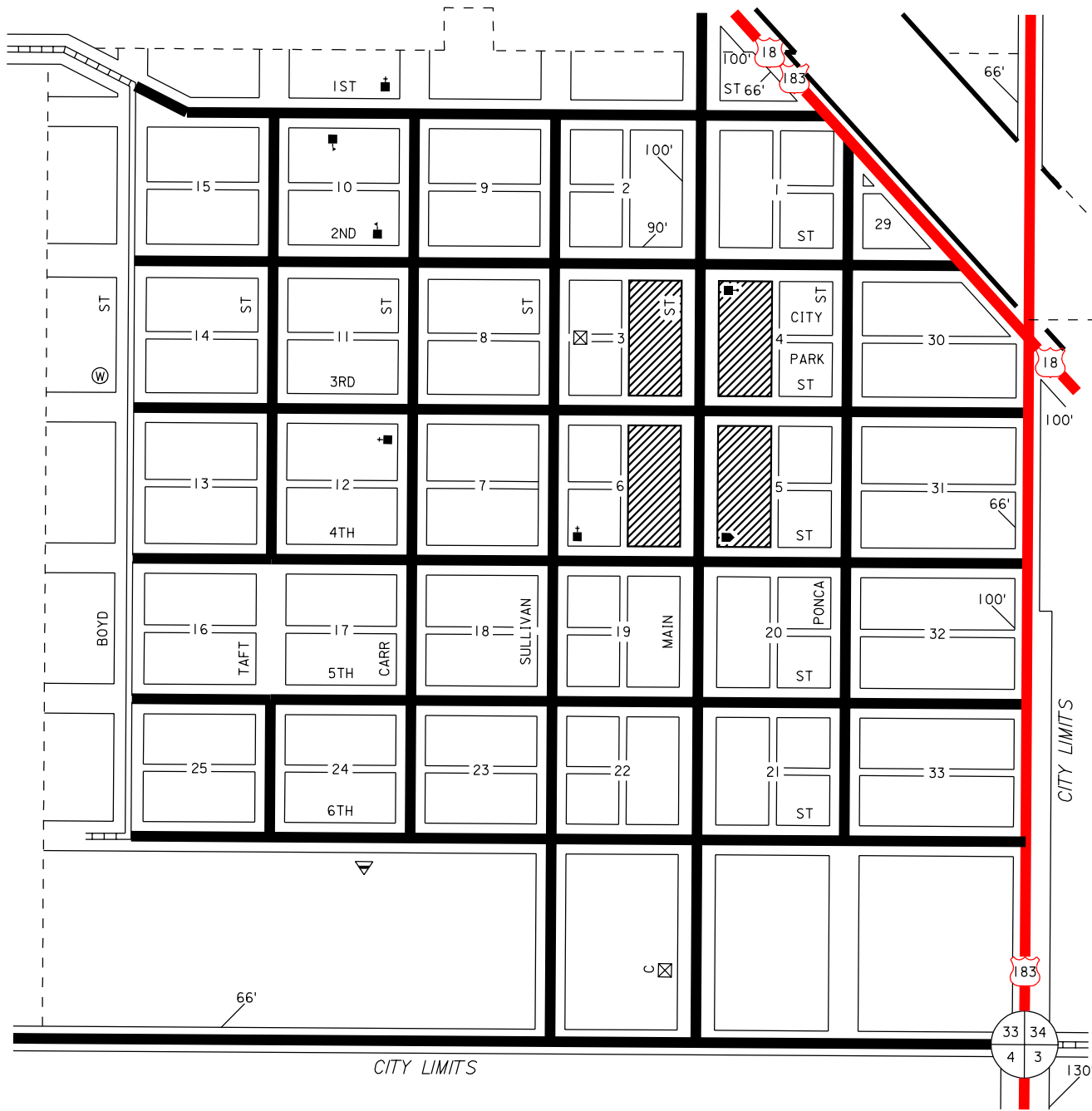

CADD PRODUCED BY CARTOGRAPHIC SECTION SOUTH DAKOTA DEPARTMENT OF TRANSPORTATION

RESTRICTION OF LIABILITY: The SD-DOT make no claims, promises or guarantees about the accuracy, completeness, or adequacy of the data and expressly disclaims liability of errors and omissions of the data content. No warranty of any kind, implied, expressed or statutory, including but not limited to the warranties of non-infringement of third party rights, title, merchantability and fitness for a particular purpose is given with respect to this data.