



CITY MAP
CUSTER CITY
 CUSTER COUNTY - SOUTH DAKOTA
 T 3 S - R 4 E

SCALE
 0 300ft.

POP. 1,860 (2000)

2009

PREPARED BY

SOUTH DAKOTA
 DEPARTMENT OF TRANSPORTATION

IN COOPERATION WITH
 U.S. DEPARTMENT OF TRANSPORTATION
 FEDERAL HIGHWAY ADMINISTRATION

ALL STREET RIGHT OF WAY 100 FT.

ALLEYS 30 FT.

(UNLESS OTHERWISE INDICATED)

(UNOFFICIAL EDITION)

LEGEND

- U.S. NUMBERED HIGHWAY
- U.S. NUMBERED INTERSTATE HIGHWAY
- STATE NUMBERED HIGHWAY
- STREAMS, CREEKS, AND OTHER WATERWAYS
- CANALS, LATERALS, IRRIGATION DITCHES
- WITH DIRECTION OF FLOW
- HARD SURFACE
- GRAVEL SURFACE
- EARTH SURFACE
- UNIMPROVED
- TRAIL
- GRADE
- CENTRAL BUSINESS DISTRICT
- TOWN CENTER (COUNTY SEAT)
- CITY LIMITS
- RAILROAD
- GRAN ELEVATOR
- SWIMMING POOL
- BALL FIELD
- CEMETERY
- HOSPITAL
- HIGHWAY GARAGE (IC-COUNTY, S-STATE)
- POST OFFICE
- CHURCH
- LIBRARY
- POWER PLANT
- WATER SUPPLY STAND PIPE OR TANK
- MUNICIPAL BUILDING
- BULK PLANT
- FIREHALL
- SCHOOLHOUSE
- TOWNHALL
- MUSEUM
- POLICE STATION
- AIRPORT

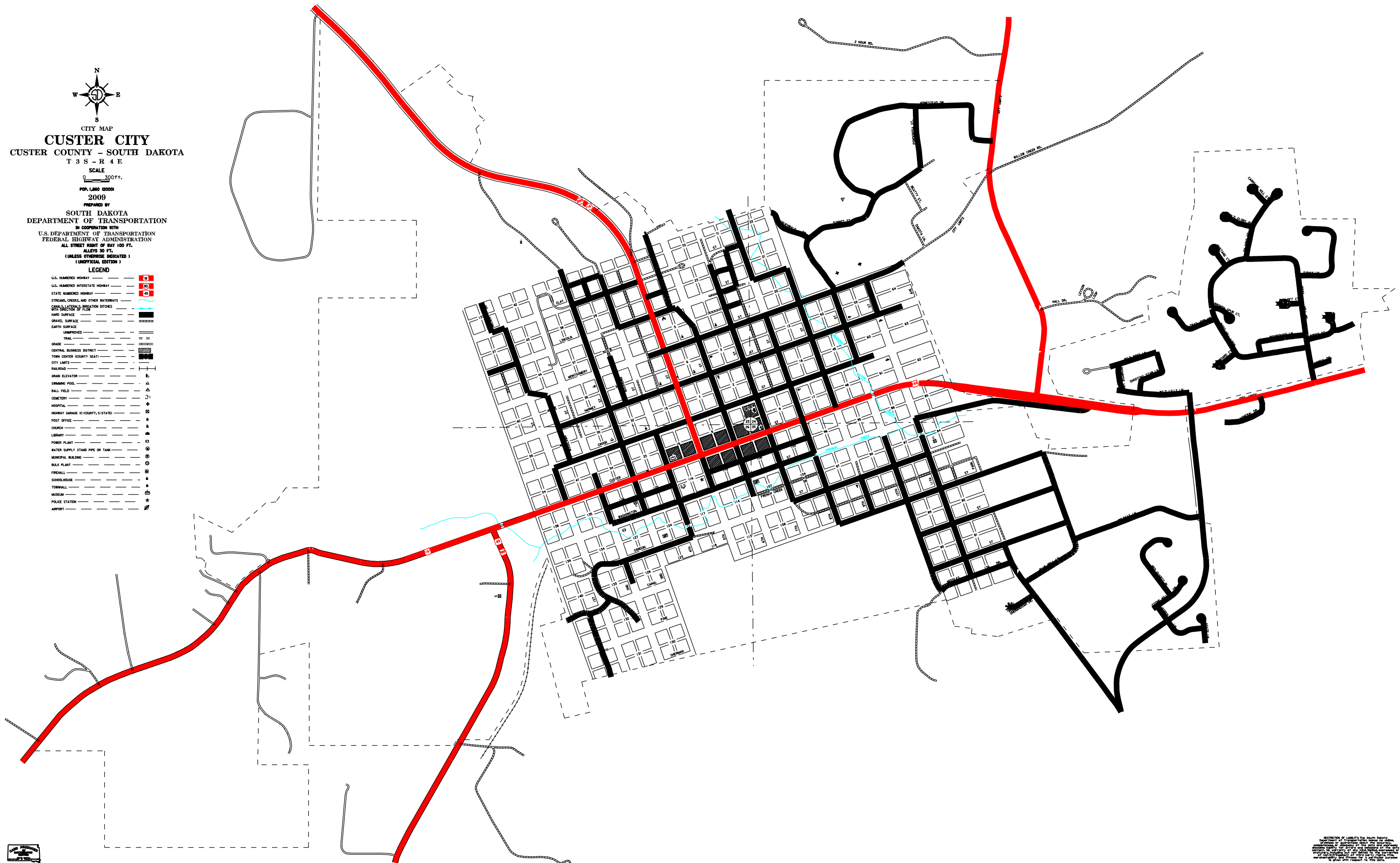

RESTRICTIONS OF LIABILITY: The South Dakota Department of Transportation makes no warranty, express or implied, for the accuracy, completeness or suitability of this information for any purpose. The user assumes all liability for any and all use of the information. The Department of Transportation is not responsible for any and all use of the information for any purpose. The Department of Transportation is not responsible for any and all use of the information for any purpose.